

Venango County Line

Garvin Dimon & Co.

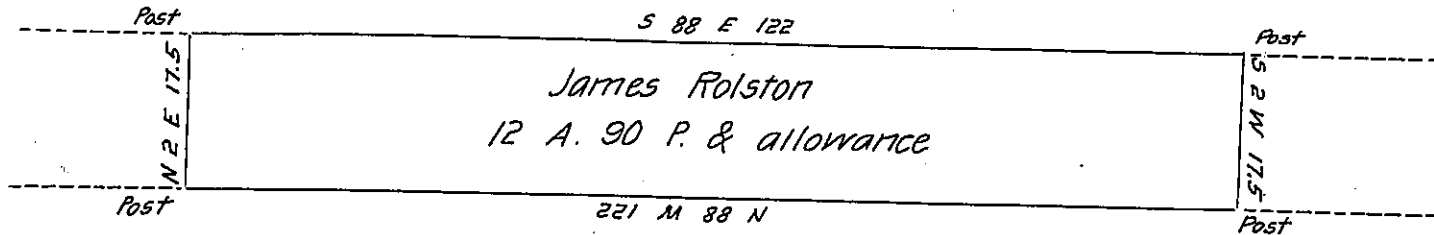

Henry V. MORG & Co.

E. F. Heter

Draft of a tract of land containing twelve acres ninety perches  
 and allowance of Six per Cent for Roads &c. Situated in Ashland township  
 County of Clarion Surveyed the 21<sup>st</sup> day of September 1870 in pursuence of a  
 warrant granted to James Rolston dated the 9<sup>th</sup> day of August A.D. 1870

Samuel Conner C. S.

To

J. M. Campbell

Surveyor General

IN TESTIMONY that the above is a copy of the original remaining on file in  
 the Department of Internal Affairs of Pennsylvania, made  
 conformably to an Act of Assembly approved the 16th day of  
 February, 1833, I have hereunto set my Hand and caused  
 the Seal of said Department to be affixed at Harrisburg,  
 this.....twenty.....sixth.....day of.....September.....1906

*George D. Brown*  
 Secretary of Internal Affairs.